



10 Howes Crescent, Bishopdown, Salisbury, Wiltshire, SP1 3FU

£1,350

A superb end terrace family home together with part-walled garden and two parking spaces.

Directions

A superb end of terrace family home in sought after location

From Salisbury, take the A30 London Road. At the second roundabout take the first left into Pearce Way. Take the third right into Burden Drive, turning left at the T junction and first left into Saunders Avenue. Take the first right into Howes Crescent and at the T junction turn left, where No. 10 will be seen on the left hand side.

Description

Modern, end of terrace family home in good order throughout, in a great location on the edge of the Riverdown Park development. The accommodation consists of hall, sitting room, kitchen, cloakroom, three bedrooms, en-suite shower room and family bathroom. There is a part-walled garden facing west, two parking spaces, double glazing and gas central heating. The property is being freshly decorated throughout and will benefit from new carpets/flooring in some areas.

The Council Tax Band is 'D' and the payment for the year 2022/2023 payable to Wiltshire Council is £2191.82.

Ground Floor

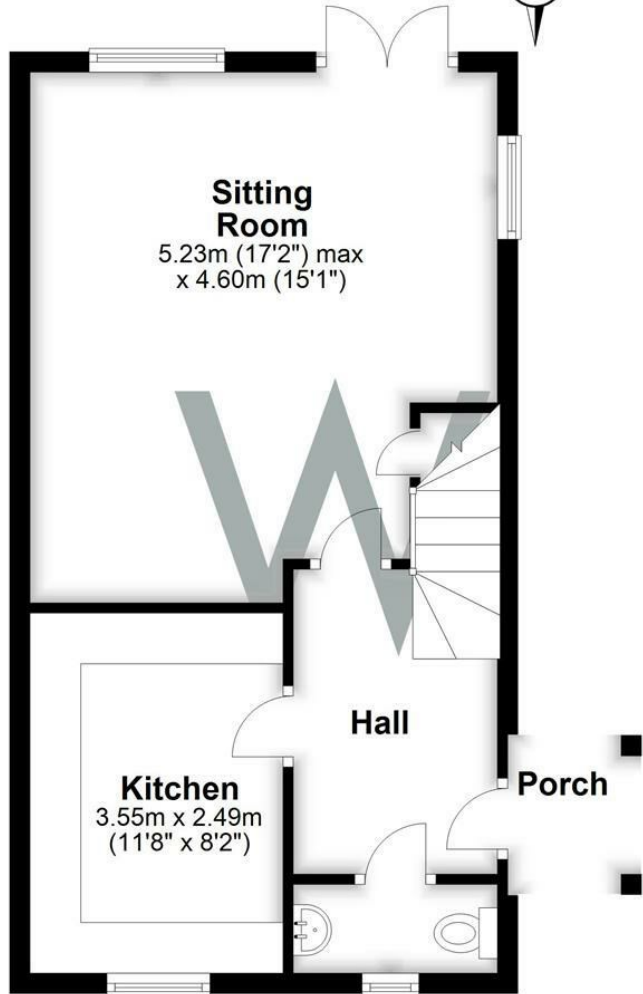
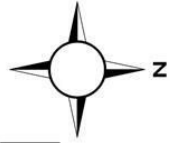

First Floor

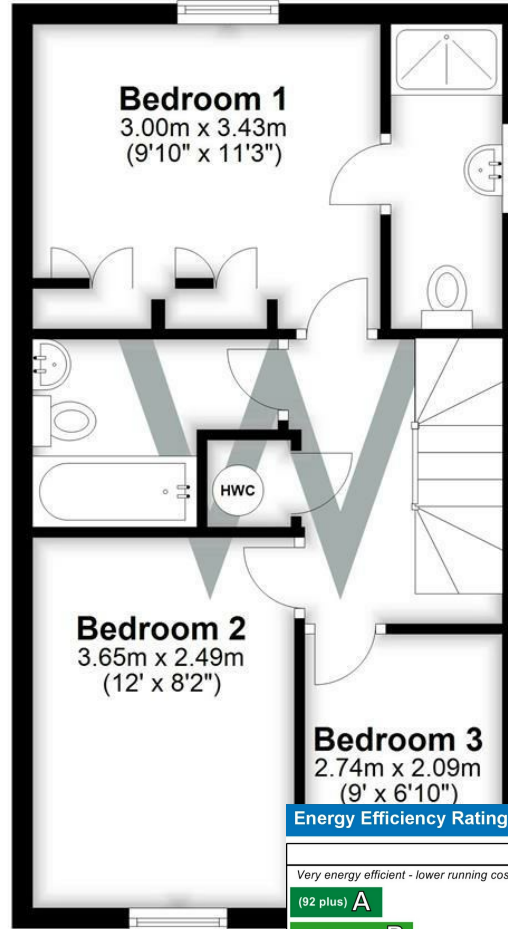

Total area: approx. 82.0 sq. metres (882.6 sq. feet)



Energy Efficiency Rating

	Current	Potential
Very energy efficient - lower running costs		
(92 plus) A		95
(81-91) B	83	
(69-80) C		
(55-68) D		
(39-54) E		
(21-38) F		
(1-20) G		
Not energy efficient - higher running costs		
England & Wales	EU Directive 2002/91/EC	

WHITES
 Castle Chambers, 47 Castle Street,
 Salisbury, Wiltshire, SP1 3SP
 01722 336422
 www.hwwhite.co.uk
 residential-sales@hwwhite.co.uk

